

# CPH CHALLENGER SERIES PEDESTALS

CPH911, CPH920, CPH1022



Stake  
(S2 Shown)



Bracket  
(B2 Shown)



Lock  
(L00 Shown)



Self-locating  
Cover Security  
Lock Receiver



Winterized Drop  
(A1 Shown)



42" Joint Trench  
Stake (2 per ctn.)  
P/N ST01001

Designed specifically for housing passive equipment, these special versions of the Channell CPH911, CPH920, and CPH1022 pedestals feature direct-bury bases with a high rib design that are less likely to lean or tilt and do not require stakes for installation. A special self-locating cover ensures that the pedestals lock properly without additional alignment. The covers include Channell's Self-Lock<sup>®</sup> security hardware.

## FEATURES

- **9" and 10" diameter round profiles provide maximum workspace and bend radius provisions for all passives, cables and connectors**
- **Round pedestal style maintains a consistent look with legacy pedestals in the field**
- **Constructed of durable, high-strength materials for maximum security and long service life**
- **Universal equipment mounting bracket for passives facilitates installation**
- **Optional stake mounting provision for joint trench or other special applications**

# PART NUMBER MATRIX

	CPH	XXXX	CX	BX	SX	LXX	AXX
Challenger Pedestal Housing	_____						
Size	_____						
911	9" x 11" (230mm x 280mm)	1022	10" x 22" (250mm x 560mm)				
920	9" x 20" (230mm x 510mm)						
Color	_____						
C1	Light Green	C2	Beige	C3	Dark Green		
Bracketry	_____						
B1	Standard Bracketry Included in Stake						
B2	Slotted Bracket						
Stake Configuration	_____						
S1	No Stake (Ground Skirt)						
S2	Stake						
Self-Lock® Security System Lock Type	_____						
L00	Hex-Head						
L01	Standard						
LB1	Channell Pattern 11						
Accessories	_____						
A0	No Accessory Options						
A1	Winterized Drop						

## DIMENSIONS

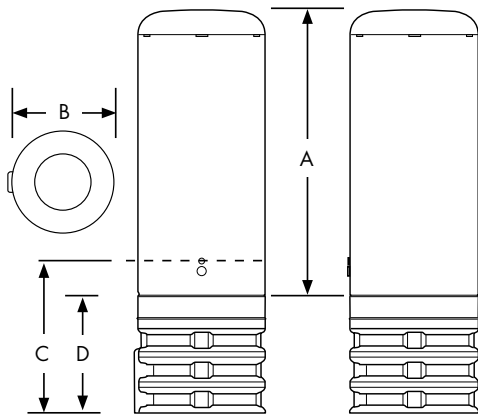

	A	B	C	D
CPH 911	13.0" (330mm)	9.5" (240mm)	14.5" (370mm)	10.5" (265mm)
CPH 920	22.0" (560mm)	9.5" (240mm)	14.5" (370mm)	10.5" (265mm)
CPH 1022	24.0" (610mm)	10.75" (275mm)	14.5" (370mm)	10.5" (265mm)

Note: Dimensions in inches (mm)



## CHANNELL

Where The Industry Connects.

**WORLDWIDE HEADQUARTERS:** Channell Commercial Corporation, Rockwall, TX, United States • Tel 800.423.1863 • Fax 951.296.2322

**CANADA:** Channell Canada, Inc., Mississauga, ON, Canada • Tel 905.565.1700 • Fax 905.565.8282

**EUROPE, MIDDLE EAST, AFRICA:** Channell Ltd., Dartford, United Kingdom • Tel 44.1322.312590 • Fax 44.1322.508490

**AUSTRALIA, ASIA, PACIFIC RIM:** Channell Pty. Ltd., Seven Hills, NSW, Australia • Tel 61.2.8884.4111 • Fax 61.2.8814.8841

**DEVELOPING LOCATION:** Mexico City, D.F., Mexico

[www.channell.com](http://www.channell.com)

All specifications subject to change without notice. © 2020 Channell Commercial Corporation. All rights reserved.